

Stirling Place

Hove





We know just the place...



Stretching out across the ground floor of a classic period property in the heart of Hove, this impeccably stylish flat offers a superior lifestyle with a south-facing landscaped garden and the added bonus of a garage. Ideal for a first time buyer, a beautifully presented light filled layout has an enviable sense of space and includes a superbly large reception room with plenty of period charm, an excellent Shaker-style kitchen/dining room with bi-fold doors to the decked terrace, a double bedroom with plenty of storage and a stylish modern wetroom. The beach and the bustling independent cafes and shops of Portland Road and Blatchington Road are all only a short stroll from your door and the mainline station is only just over half a mile away.



1



1



1



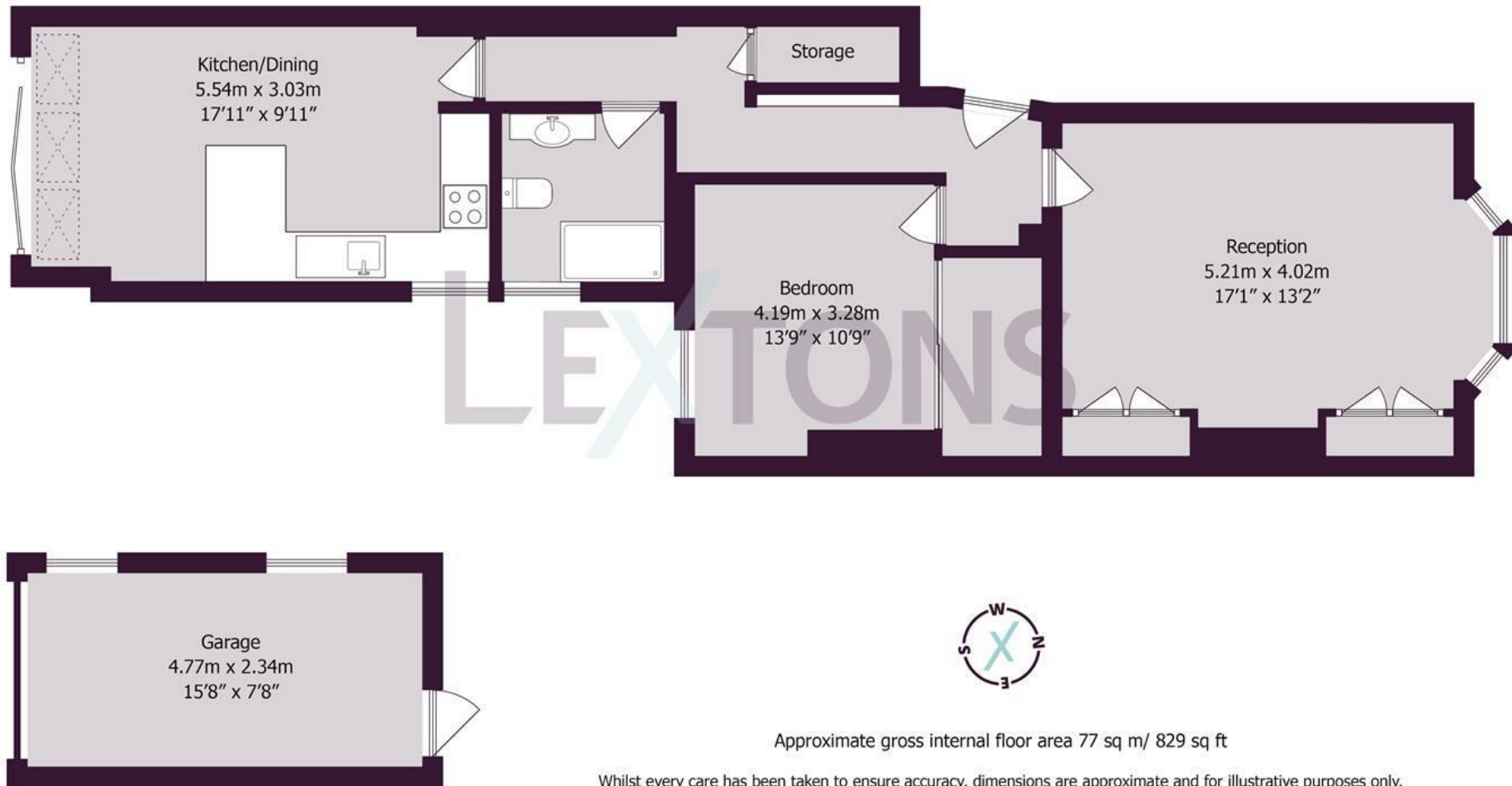

Meet us here...
174 Church Road
Hove
BN3 2DJ

We aim to make our particulars both accurate and reliable. However they are not guaranteed; nor do they form part of an offer or contract. If you require clarification on any points then please contact us, especially if you're traveling some distance to view. Please note that appliances and heating systems have not been tested and therefore no warranties can be given as to their good working order.